

## Piston

### Special Tool(s)

<p>ST1336-A</p>	Service Set, Piston Pin 303-S024 (T68P-6135-A)
-----------------	---

### Material

Item	Specification
Motorcraft® SAE 5W-30 Premium Synthetic Blend Motor Oil XO-5W30-QSP (US); Motorcraft® SAE 5W-30 Super Premium Motor Oil CXO-5W30-LSP12 (Canada); or equivalent	WSS-M2C929-A

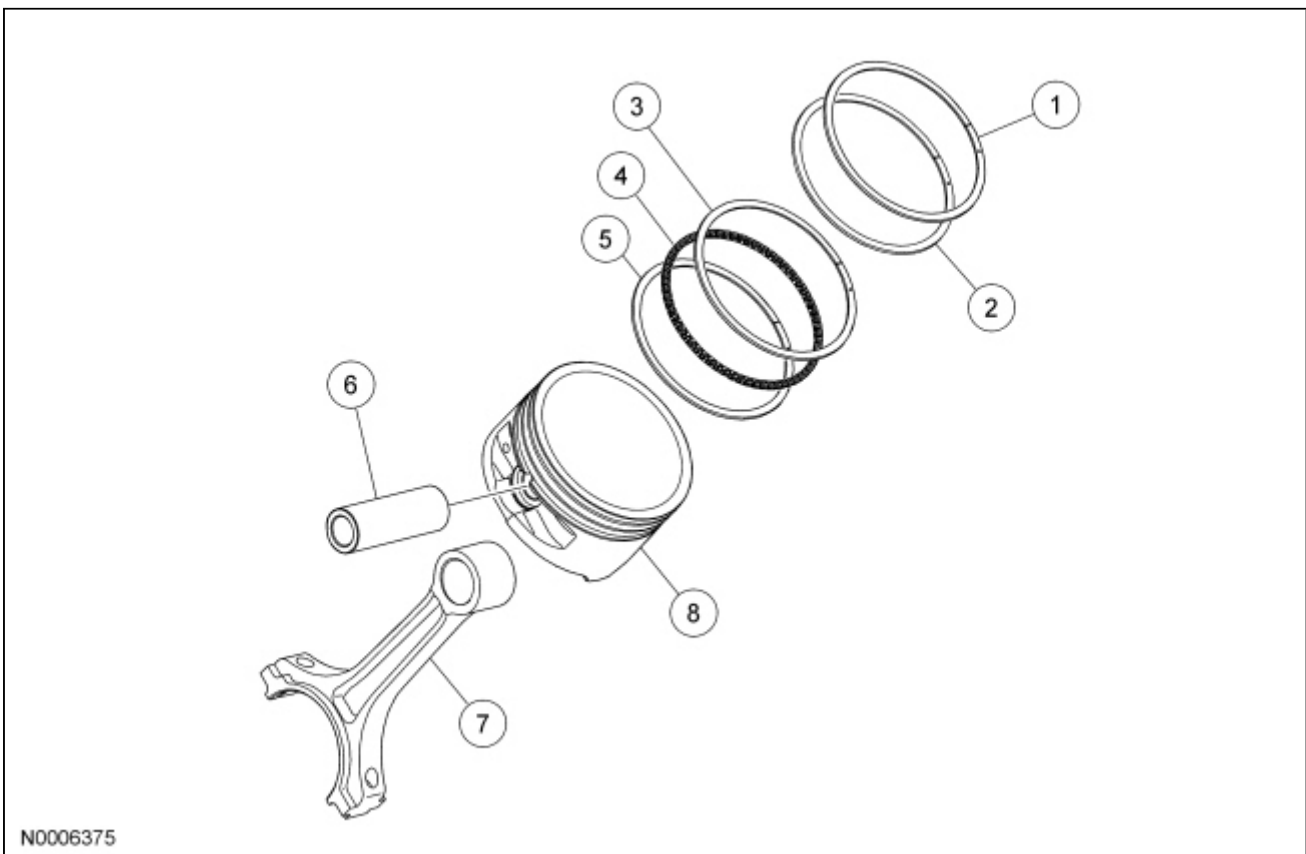

Item	Part Number	Description
1	6150	Piston compression upper ring
2	6152	Piston compression lower ring
3	6159	Piston oil control upper segment ring
4	6161	Piston oil control spacer
5	6159	Piston oil control lower segment ring

6	6135	Piston pin
7	6200	Connecting rod
8	6110	Piston

## Disassembly

**NOTE:** The connecting rod bolts and nuts cannot be reused.

**NOTE:** Mark the position of the parts, so they can be installed in their original positions.

1. Remove the connecting rod bearings from the connecting rod and cap.
2. Remove the piston rings from the piston.
3. Using the Piston Pin Service Set, press the piston pin out of the connecting rod and piston assembly.

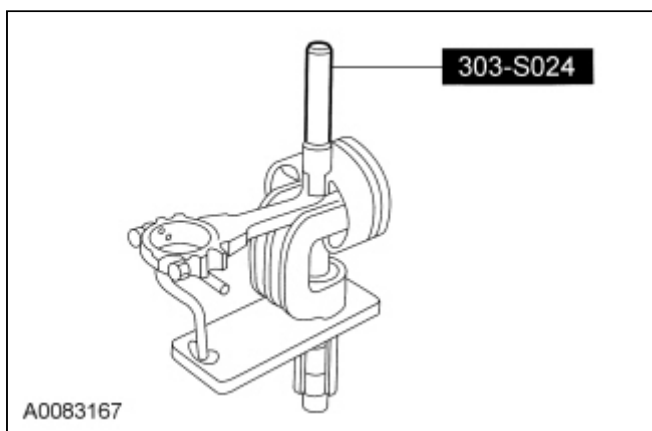

## Assembly

**NOTE:** Lubricate all parts with clean engine oil.

**NOTE:** Install the piston in the connecting rod with the cylinder number side of the rod and the indentation notch in the piston on the same side.

**NOTE:** The oil hole in the connecting rod must face the RH side of the cylinder block and the arrow on the piston must face the front of the engine block.

1. **NOTE:** If the piston pin is removed from the piston, a new piston and piston pin must be used. Do not reuse the piston or the piston pin.

Gradually heat the pin bore side of the connecting rod to approximately 232°C-316°C (467°F-626°F) and immediately install the piston pin.

2. Using the Piston Pin Service Set, press the piston pin into the piston and connecting rod assembly.

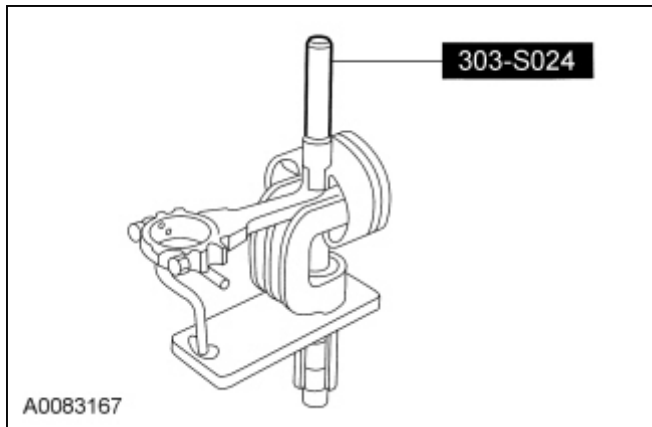

3. Install the piston rings.
4. Make sure the ring gaps (oil spacer-A, oil ring-B, compression ring-C) are correctly spaced around the circumference of the piston.

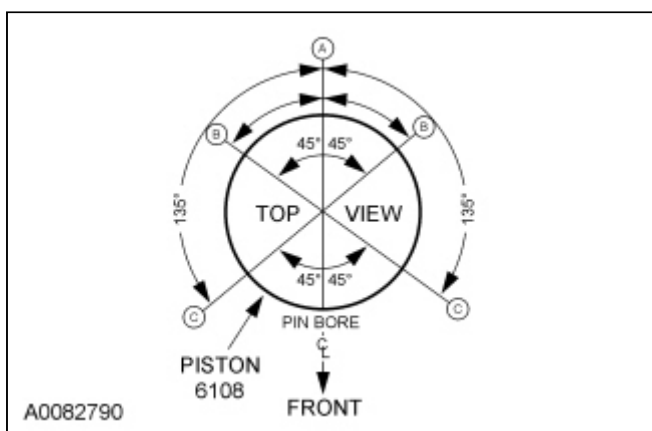

5. Install the connecting rod bearings in the connecting rod and cap.
-